

FISHEYE

USER GUIDE



Welcome to the world of TRNDlabs products!

TRNDlabs products are design focused electronics, engineered to combine ultimate performance and aesthetics.

WWW.TRNDLABS.COM

PACKAGE CONTENTS

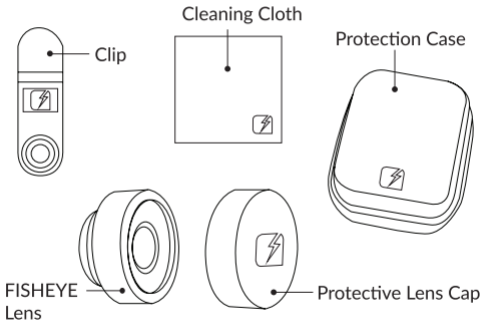

FUNCTIONS

Lens Front

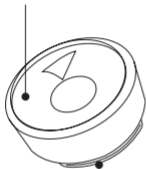

Mount

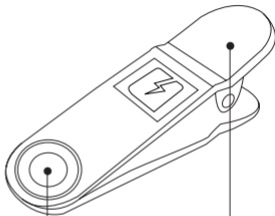

Opening Clip

Connection Ring/Mount

SPECIFICATIONS

Weight	14 gram (0.49 ounce)
Size	25 mm x 15 mm (W x H)
Angle	198°

SETUP

- 1 Put the FISHEYE lens on top of the lens mount.
- 2 Turn the lens clockwise until it fastens securely.

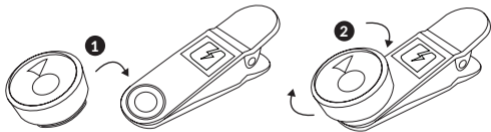

ATTACH TO YOUR PHONE

- 1 Press the small end of the clip together to open the clip.
- 2 Slide the clip over the phone and position it exactly above the camera of the phone and release the pressure on the clip carefully.
- 3 The FISHEYE is now ready to use.

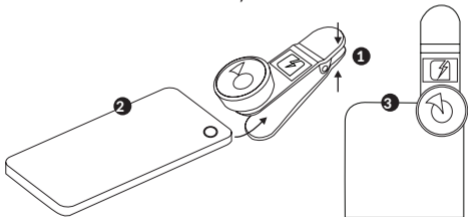

TROUBLESHOOTING



There is a black circle around the photo.

The black circle or halo is caused by the lens itself.



This is normal for fisheye photos.



The view is skewed.

The lens is mounted incorrectly.



Remove the lens from the mount and remount it.

SAFETY PRECAUTIONS

Do not use FISHEYE in temperatures below -20°C or above 40°C or in a humidity higher than 85%.

Store FISHEYE in a dry place. Never store it somewhere moist.

Do not try to alter or disassemble FISHEYE. If there is a problem with FISHEYE, contact the retailer for further assistance.

This product is not a toy, please keep away from children.



The contents of this document are subject to change.
Download the latest version from
www.trndlabs.com.

If you have any questions about this document, please contact
TRNDlabs
by sending a message to hello@trndlabs.com.

© 2016 TRNDlabs. All rights reserved.



WWW.TRNDLABS.COM